

1. Cafetería / Cafeteria
2. Baños / Restroom
3. Café Expresso
4. Banco de Sangre / Blood bank
5. Ascensores / Elevators

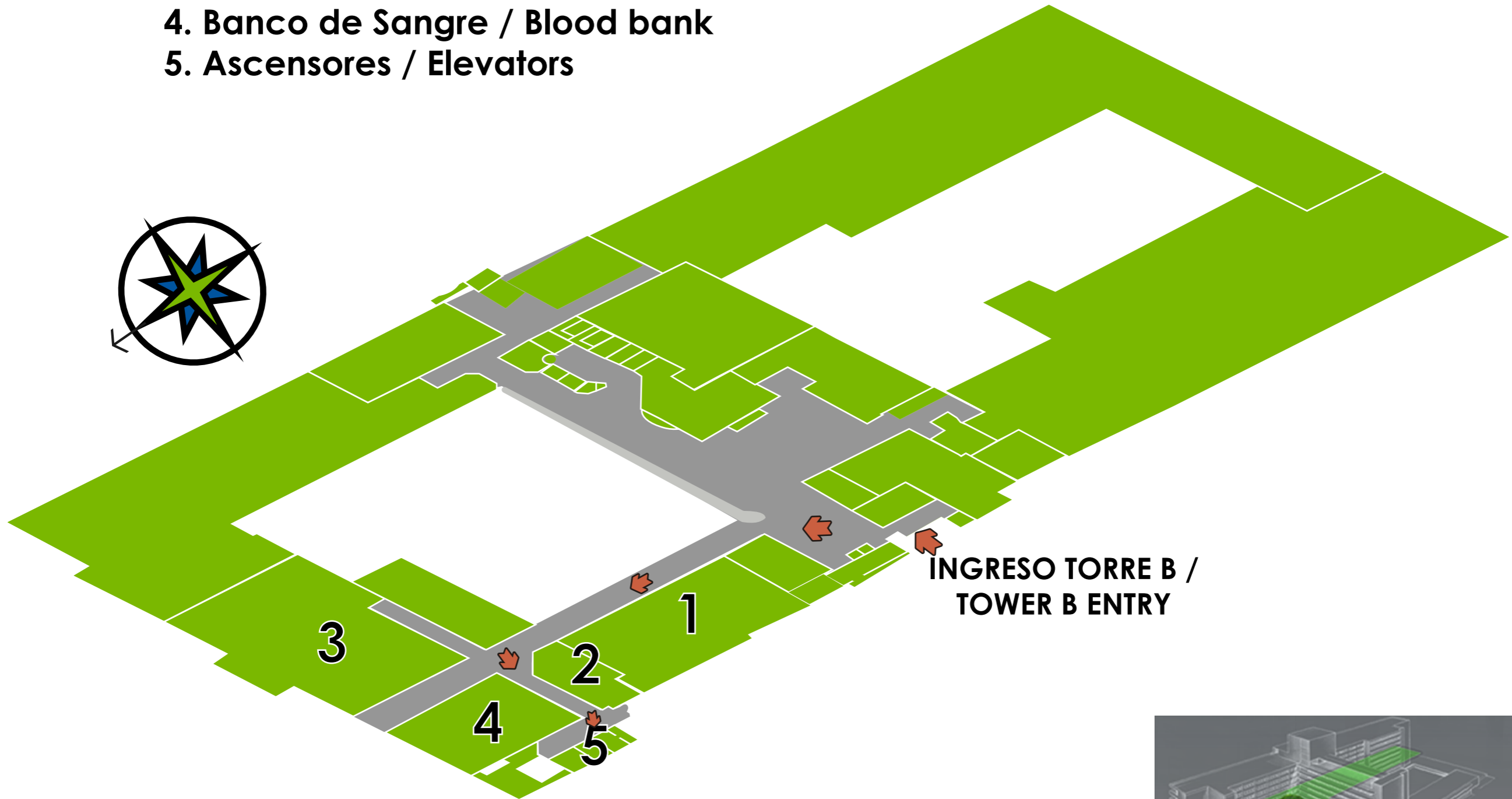

INGRESO TORRE B /
TOWER B ENTRY

1 PRIMER PISO / FIRST FLOOR
TORRE B / TOWER B

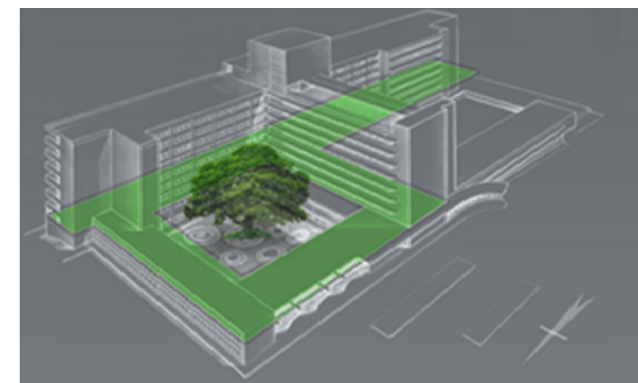

1. Ascensores / Elevators
2. Centro de Documentos / Documents center
3. Salud Ocupacional / Occupational Health Administration
4. Tecnología de la Información / Tech department
5. Oficina de Pacientes Internacionales / International Office

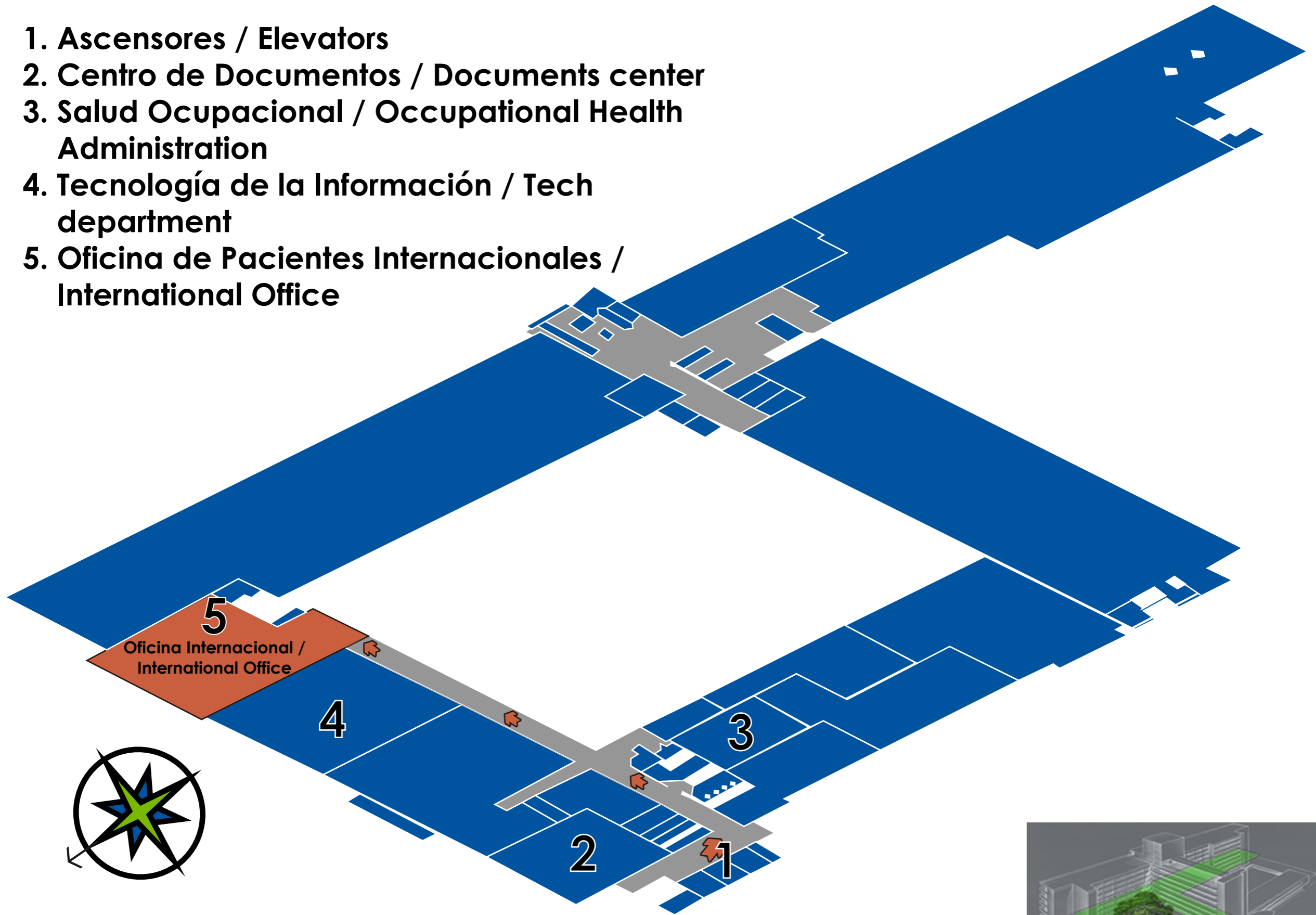

**3 TERCER PISO / THIRD FLOOR
TORRE B / TOWER B**

